

BASE CABINETS

General Requirements

- Prepare a protective layer prior to unboxing to prevent scratches on finished surfaces.
- All wood joints must have wood glue applied prior to assembly including drawer dovetails.
- Excess glue should be cleaned prior to drying.
- Follow specific glue recommendations for application and open times.
- Ensure panels are fully seated in grooves and top and bottom are flush with the face frame.

Supplies and Tools (not included)

- Protective covering for work table
- Drill with P2 Phillips bit (Ensure torque is set not to strip)
- Wood glue
- Wood clamp
- Rubber mallet

Tips and Tricks

- The L-bracket inside cabinet can be hidden behind the shelf.
- On larger cabinets, clamps may be used when installing the back panel to ensure it is flush with the end panels.



This icon indicates a step that requires wood glue.

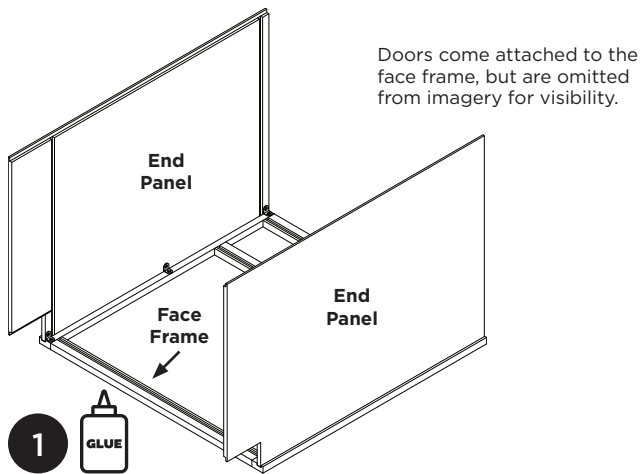

Place the face frame on covered work bench with doors facing down. Insert glue in face frame grooves and then place end panels into frame and attach with L-brackets. Ensure groove for back panel is facing up as shown.

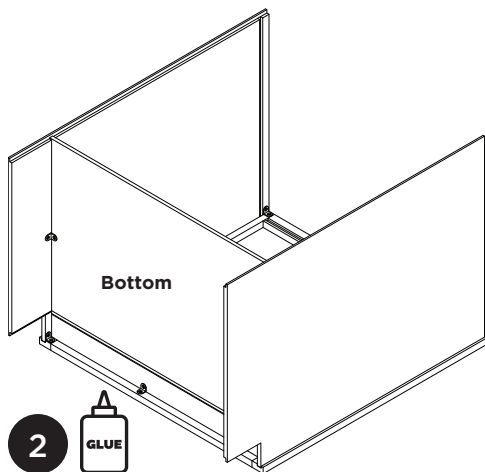

Insert glue into face frame and end panel grooves. Place the bottom into the face frame and end panels and attach to frame and both sides with L-brackets.

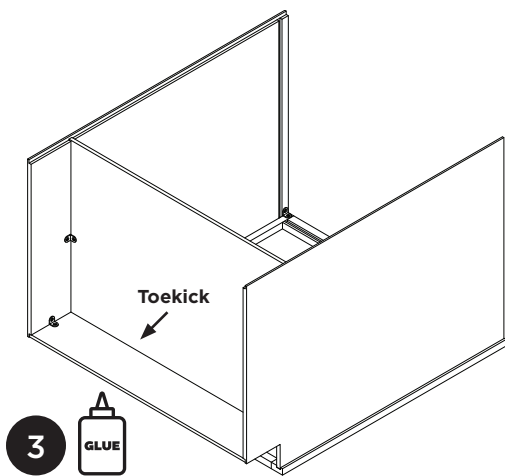

Insert glue into the groove on the bottom panel. Place the toe kick into the end panels bottom groove. Attach the toe kick to both end panels with L-brackets.

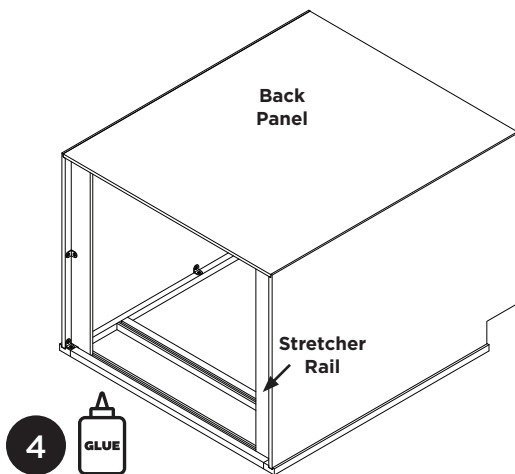

Insert glue into grooves in end panels and back panel. Install stretcher rails by attaching to panels and face frame. Place back panel onto the end panels. Ensure ends are flush all around, and attach to end panels with L-brackets.

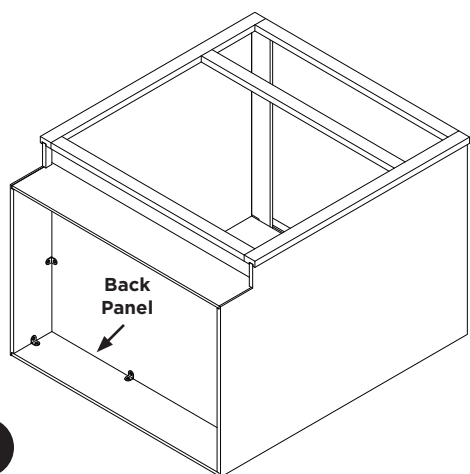

5

Flip the cabinet, then install L-brackets inside to the back and end panels.

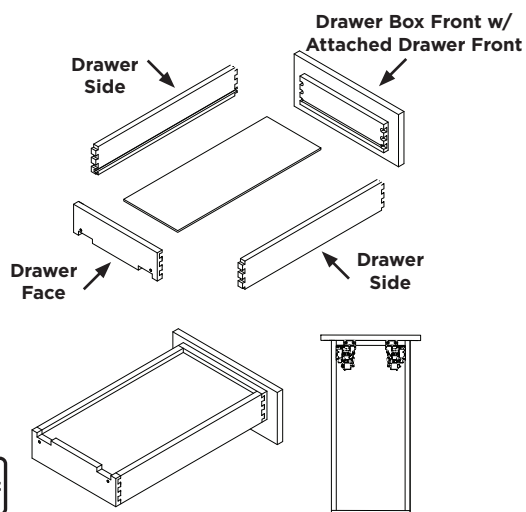

6

Insert glue into dovetail joints, then assemble box. Attach the front locking clips to the bottom of the drawer box.

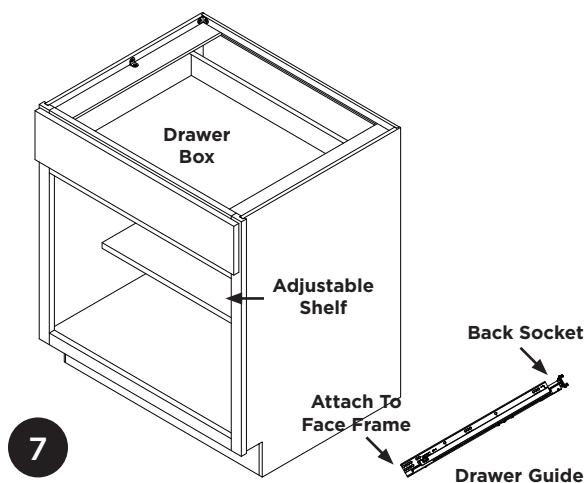

Install the drawer guides inside cabinet. Face frame holes are pre-drilled. Locate aligning holes on back panel and force fit. Place assembled drawer boxes into the cabinet. Insert shelf clips into the cabinet and install the adjustable shelf.

*Note some cabinets models' holes will need to be drilled out to 5/16" for back socket.

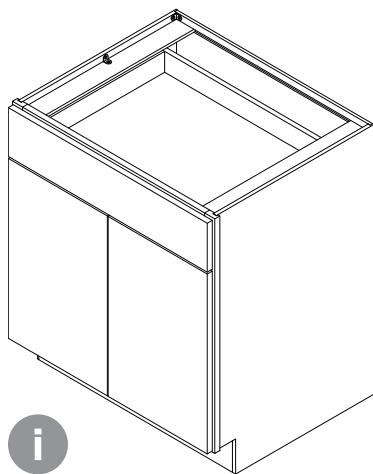

For more information about installation, please visit www.mantracabinets.com

BASE CORNER CABINETS

General Requirements

- Prepare a protective layer prior to unboxing to prevent scratches on finished surfaces.
- All wood joints must have wood glue applied prior to assembly including drawer dovetails.
- Excess glue should be cleaned prior to drying.
- Follow specific glue recommendations for application and open times.
- Ensure panels are fully seated in grooves and top and bottom are flush with the face frame.

Supplies and Tools (not included)

- Protective covering for work table
- Drill with P2 Phillips bit (Ensure torque is set not to strip)
- Wood glue
- Wood clamp
- Rubber mallet

Tips and Tricks

- The L-bracket inside cabinet can be hidden behind the shelf.
- On larger cabinets, clamps may be used when installing the back panel to ensure it is flush with the end panels.



This icon indicates a step that requires wood glue.

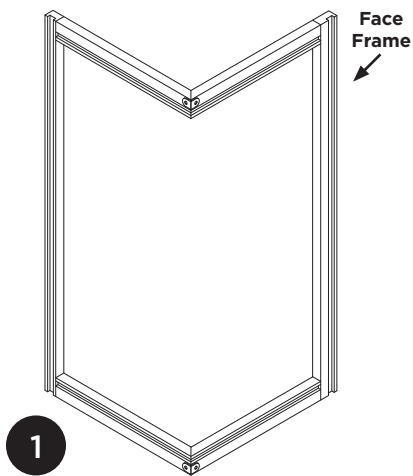

Fasten two face frames together with L-brackets.

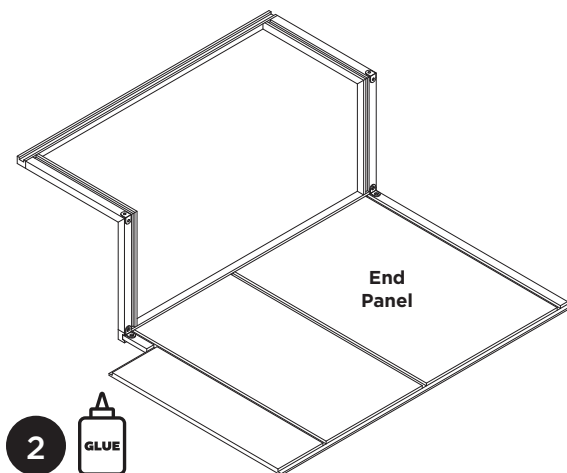

Insert glue into end panel grooves, place end panel and attach with L-brackets.

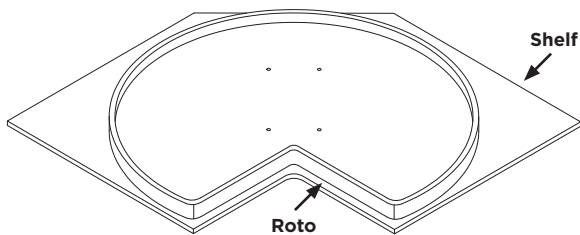

3

If applicable: Center roto on shelf ensuring the front “L” is parallel and The roto is not hanging over the edge of the shelf in any direction. Pull plug from top of roto and attach base to shelf by rotating and screwing in pre-drilled locations.

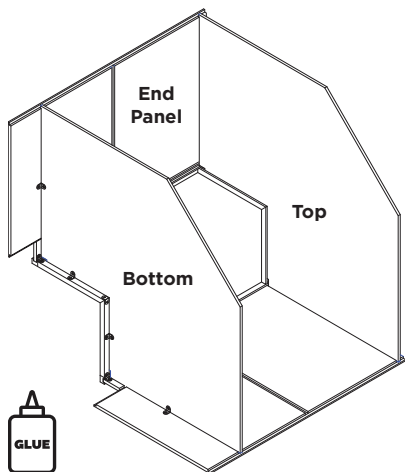

4

Insert glue into end panel grooves. Place top and bottom panels into face frame and end panel and attach with L-brackets. Place second end panel into face frame and attach with L-brackets.

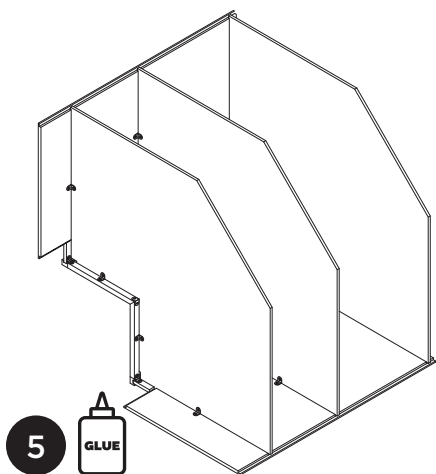

Insert glue into panel and frame grooves.
Insert fixed shelf and attach to end panels
with L-brackets.

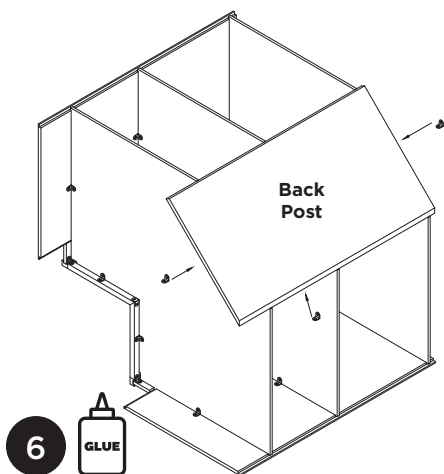

Insert glue into back panel grooves. Place
back post onto top, bottom and fixed shelf
and center it. Attach back post to top,
bottom and fixed shelf with L-brackets.

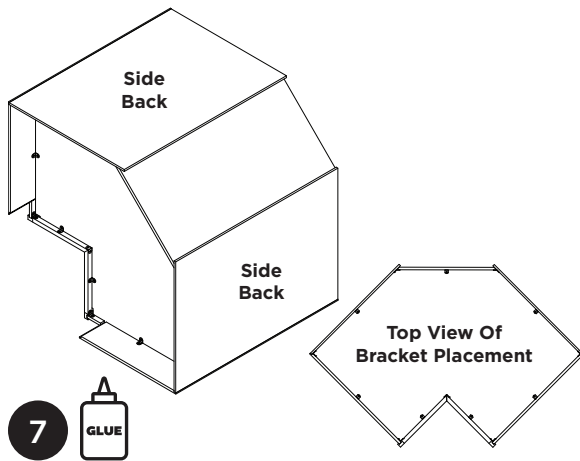

Insert glue into panel grooves. Place side back panels onto cabinet and attach to the end panel, top and bottom with L-brackets.

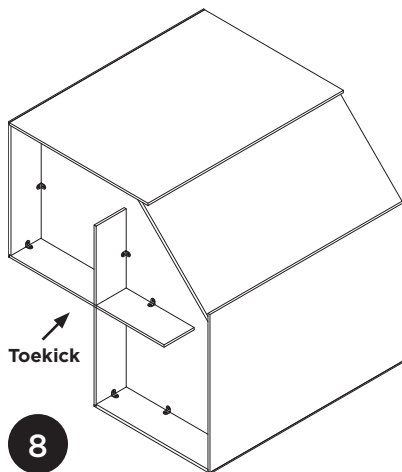

Assemble toekick and attach to end panel and bottom with L-brackets.

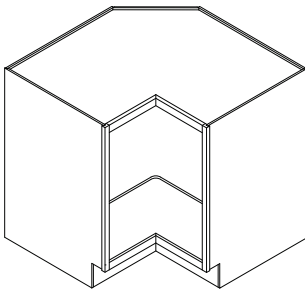

**Interior View Of
Bracket Placement**

9

From inside cabinet, attach side backs to back post and both end panels with L-brackets.

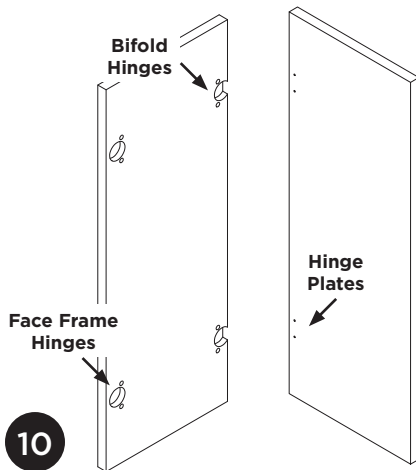

10

Install hinges onto doors as shown.

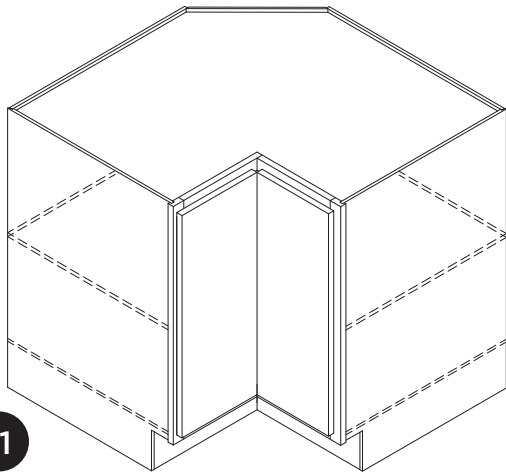

11

Attach doors to face frame.

i

For more information about installation,
please visit www.mantracabinets.com

BASE SINK REMOVABLE CABINETS

General Requirements

- Prepare a protective layer prior to unboxing to prevent scratches on finished surfaces.
- All wood joints must have wood glue applied prior to assembly including drawer dovetails.
- Excess glue should be cleaned prior to drying.
- Follow specific glue recommendations for application and open times.
- Ensure panels are fully seated in grooves and top and bottom are flush with the face frame.

Supplies and Tools (not included)

- Protective covering for work table
- Drill with P2 Phillips bit (Ensure torque is set not to strip)
- Wood glue
- Wood clamp
- Rubber mallet

Tips and Tricks

- On larger cabinets, clamps may be used when installing the back panel to ensure it is flush with the end panels.



This icon indicates a step that requires wood glue.

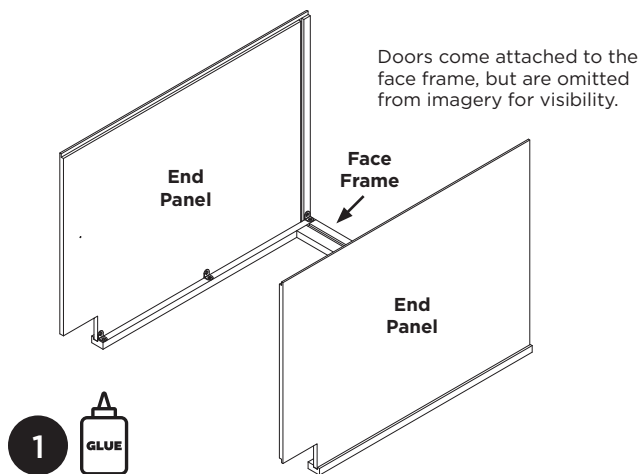

Place the face frame on covered work bench with doors facing down. Insert glue in face frame grooves and then place end panels into frame and attach with L-brackets. Ensure groove for back panel is facing up as shown.

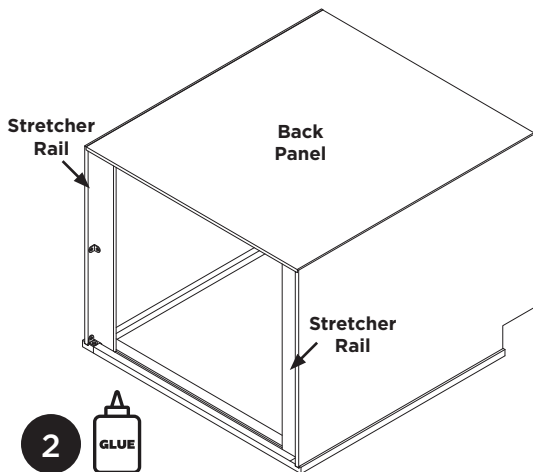

Insert glue into grooves in end panels and back panel. Install stretcher rails by attaching to panels and face frame. Place back panel onto the end panels. Ensure ends are flush all around, and attach to end panels with L-brackets.

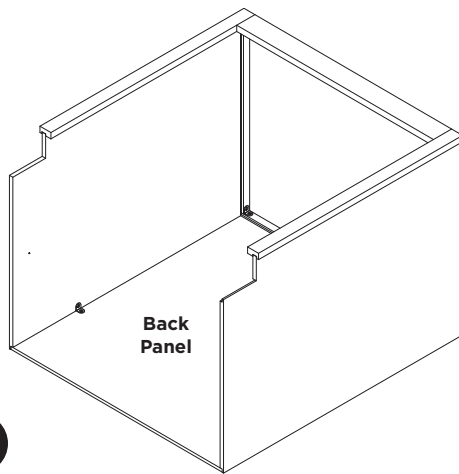

3

Holding back panel into place, flip cabinet and attach back panel to both Sides panels with L-brackets above toekick area. This provides clearance for the removable bottom panel.

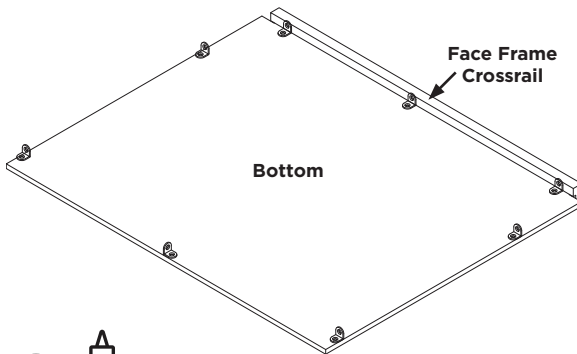

4



Insert glue into face frame rail. Attach bottom to face frame cross-rail with L-brackets. Place (5) additional L-brackets to bottom for placement onto toekick assembly.

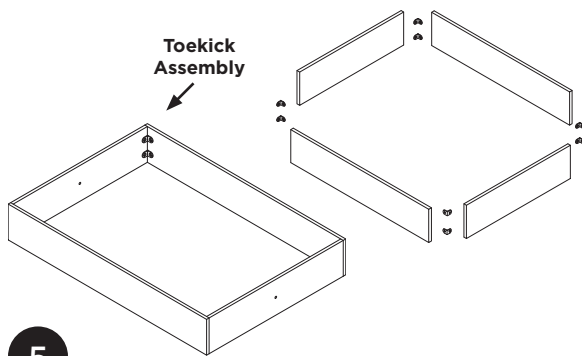

5

Assemble toekick pedestal by lining up corners in a rectangle and attach with L-brackets.

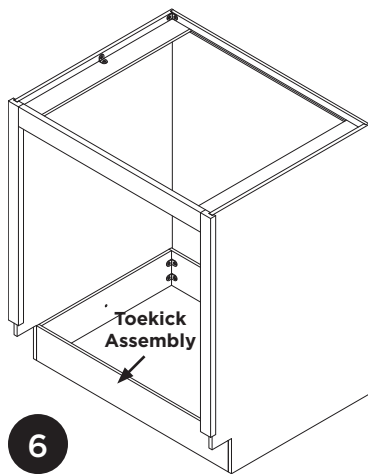

6

Placed assembled toekick into cabinet and attach to end panels with provided screws.

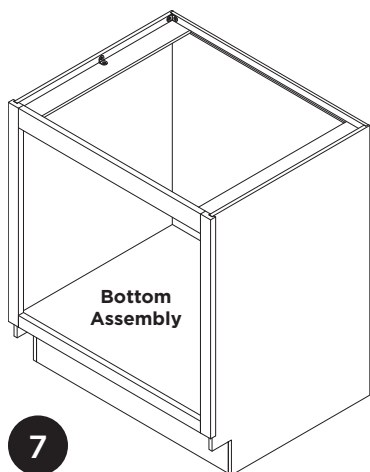

Place bottom assembly into cabinet - placing on top of toekick assembly.

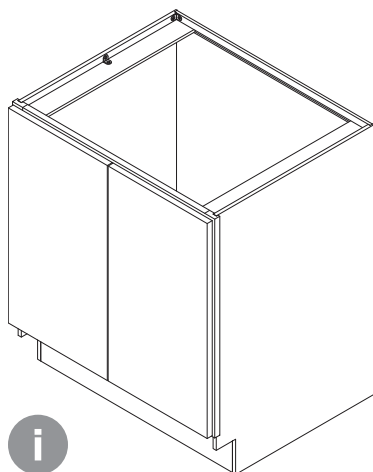

For more information about installation, please visit www.mantracabinets.com

DRAWER BASE CABINETS

General Requirements

- Prepare a protective layer prior to unboxing to prevent scratches on finished surfaces.
- All wood joints must have wood glue applied prior to assembly including drawer dovetails.
- Excess glue should be cleaned prior to drying.
- Follow specific glue recommendations for application and open times.
- Ensure panels are fully seated in grooves and top and bottom are flush with the face frame.

Supplies and Tools (not included)

- Protective covering for work table
- Drill with P2 Phillips bit (Ensure torque is set not to strip)
- Wood glue
- Wood clamp
- Rubber mallet

Tips and Tricks

- On larger cabinets, clamps may be used when installing the back panel to ensure it is flush with the end panels.



This icon indicates a step that requires wood glue.

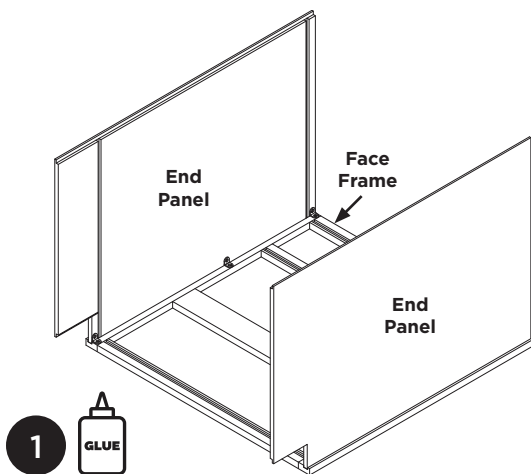

Place the face frame on covered work bench with doors facing down. Insert glue in face frame grooves and then place end panels into frame and attach with L-brackets. Ensure groove for back panel is facing up as shown.

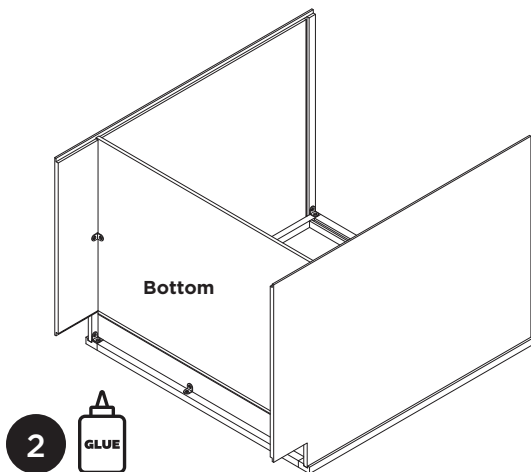

Insert glue into face frame and end panel grooves. Place the bottom into the face frame and end panels and attach to frame and both sides with L-brackets.

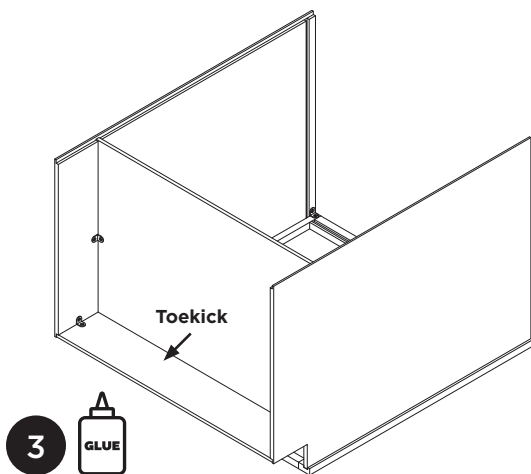

Insert glue into bottom panel and end panel grooves. Place toe kick into end panels' bottom groove. Attach toe kick to both end panels.

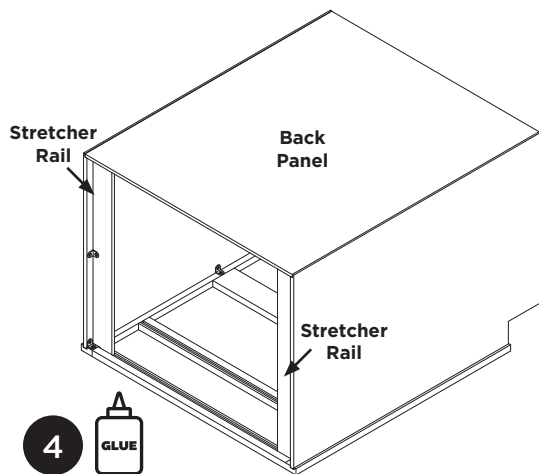

Insert glue into grooves in end panels and back panel. Install stretcher rails by attaching to panels and face frame. Place back panel onto the end panels. Ensure ends are flush all around, and attach to end panels with L-brackets.

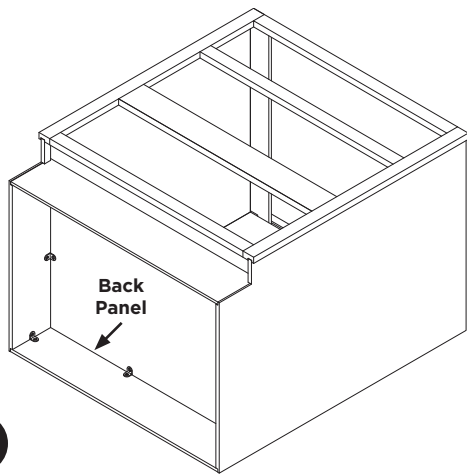

5

Holding back panel into place, flip cabinet and attach back panel to both end panels and bottom with L-brackets.

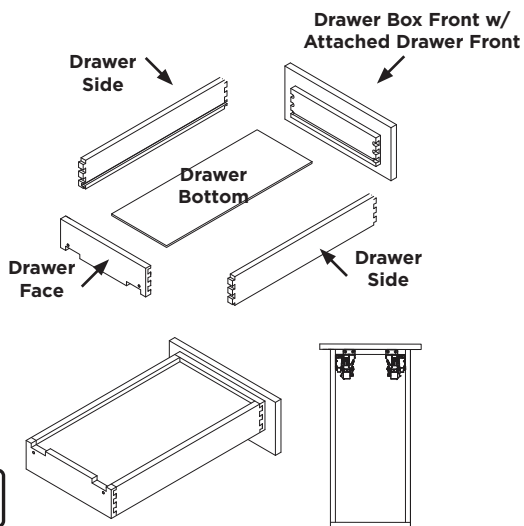

6

Insert glue into dovetail joints, then assemble box. Attach the front locking clips to the bottom of the drawer box.

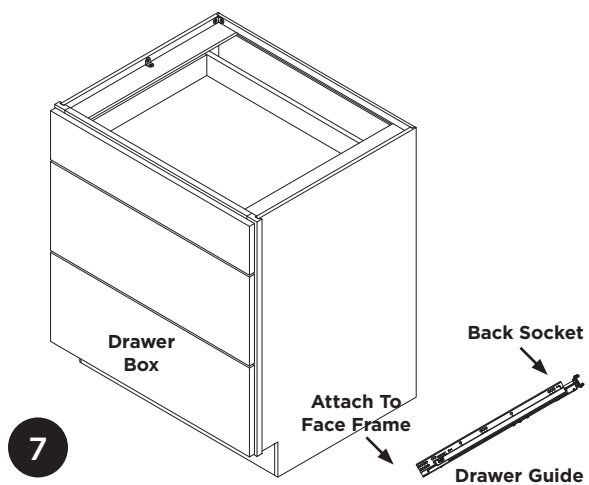

Install the drawer guides inside cabinet. Face frame holes are pre-drilled. Locate aligning holes on back panel and force fit. Place assembled drawer boxes into the cabinet.

*Note some cabinets models' holes will need to be drilled out to 5/16" for back socket.



For more information about installation, please visit www.mantracabinets.com

MICROWAVE CABINETS

General Requirements

- Prepare a protective layer prior to unboxing to prevent scratches on finished surfaces.
- All wood joints must have wood glue applied prior to assembly including drawer dovetails.
- Excess glue should be cleaned prior to drying.
- Follow specific glue recommendations for application and open times.
- Ensure panels are fully seated in grooves and top and bottom are flush with the face frame.

Supplies and Tools (not included)

- Protective covering for work table
- Drill with P2 Phillips bit (Ensure torque is set not to strip)
- Wood glue
- Wood clamp
- Rubber mallet

Tips and Tricks

- On larger cabinets, clamps may be used when installing the back panel to ensure it is flush with the end panels.



This icon indicates a step that requires wood glue.

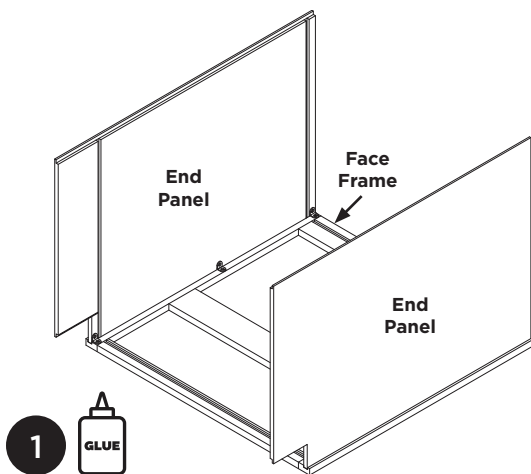

Place the face frame on covered work bench with doors facing down. Insert glue in face frame grooves and then place end panels into frame and attach with L-brackets. Ensure groove for back panel is facing up as shown.

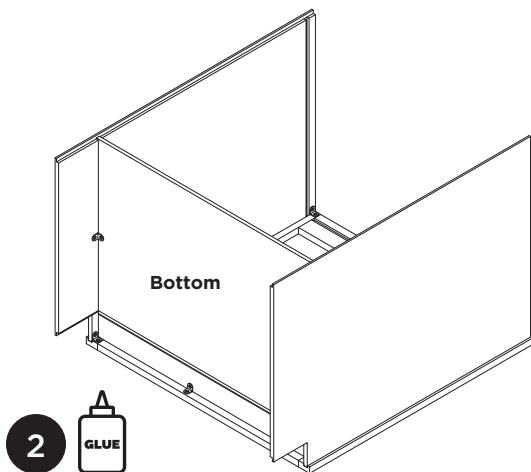

Insert glue in face frame and end panel grooves. Place the bottom into the face frame end panels and attach to the frame and both sides with L-brackets.

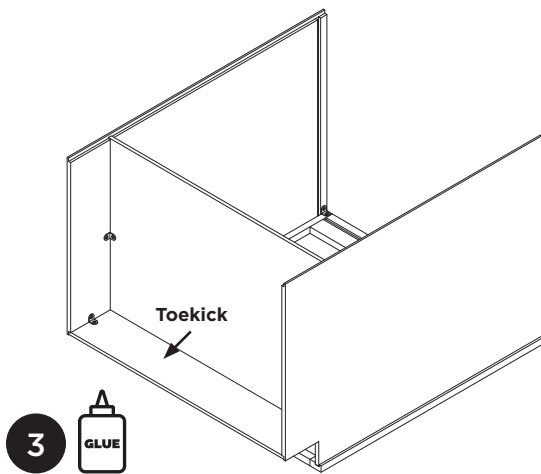

Insert glue into bottom panel and end panel grooves. Place the toe kick into the end panels' bottom groove and attach toe kick to both end panels.

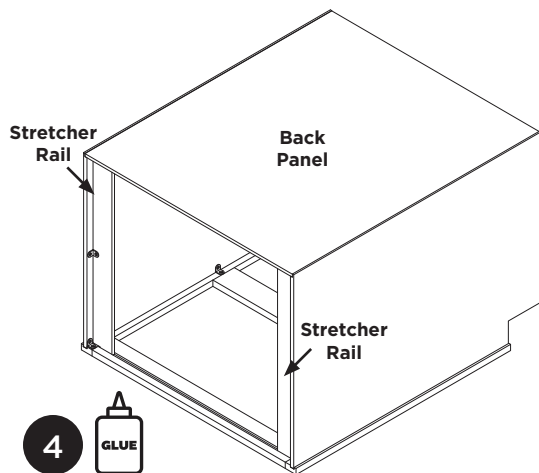

Insert glue into grooves in end panels and back panel. Install stretcher rails by attaching to panels and face frame. Place back panel onto the end panels. Ensure ends are flush all around, and attach to end panels with L-brackets.

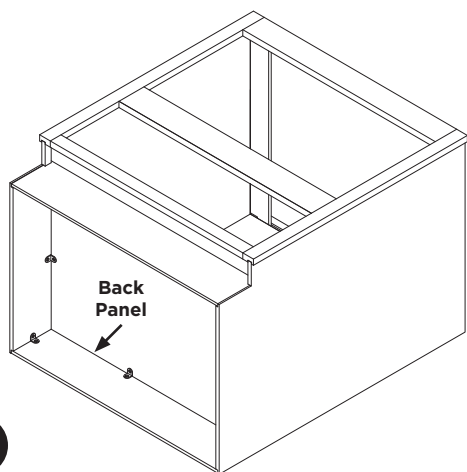

5

Holding the back panel into place, flip the cabinet and attach the back panel to both end panels and the bottom with L-brackets.

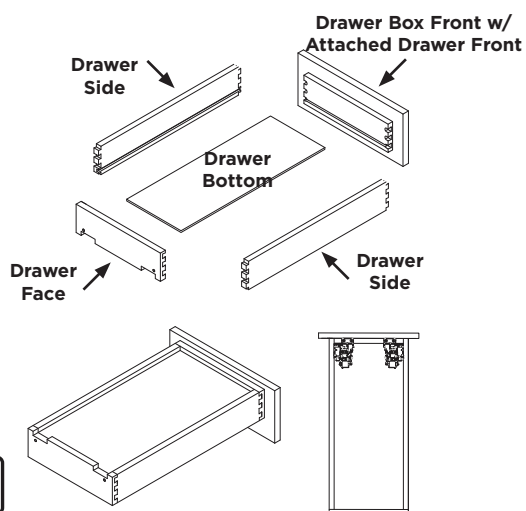

Insert glue into dovetail joints, then assemble box. Attach the front locking clips to the bottom of the drawer box.

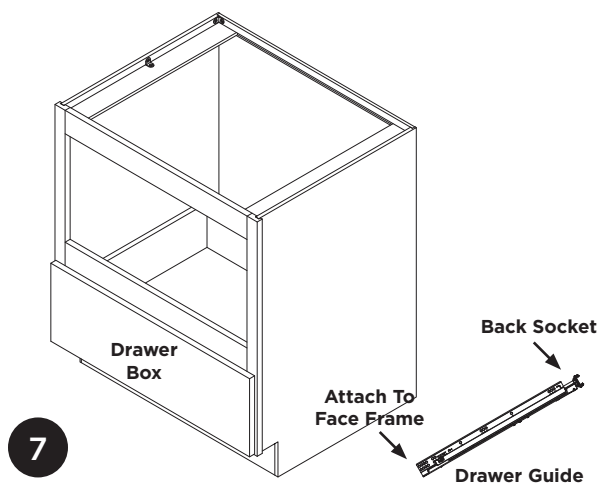

Install the drawer guides inside cabinet. Face frame holes are pre-drilled. Locate aligning holes on back panel and force fit. Place assembled drawer boxes into the cabinet.

*Note some cabinets models' holes will need to be drilled out to 5/16" for back socket.



For more information about installation, please visit www.mantracabinets.com

OVEN CABINETS

General Requirements

- Prepare a protective layer prior to unboxing to prevent scratches on finished surfaces.
- All wood joints must have wood glue applied prior to assembly including drawer dovetails.
- Excess glue should be cleaned prior to drying.
- Follow specific glue recommendations for application and open times.
- Ensure panels are fully seated in grooves and top and bottom are flush with the face frame.

Supplies and Tools (not included)

- Protective covering for work table
- Drill with P2 Phillips bit (Ensure torque is set not to strip)
- Wood glue
- Wood clamp
- Rubber mallet

Tips and Tricks

- The L-bracket inside cabinet can be hidden behind the shelf.
- On larger cabinets, clamps may be used when installing the back panel to ensure it is flush with the end panels.



This icon indicates a step that requires wood glue.

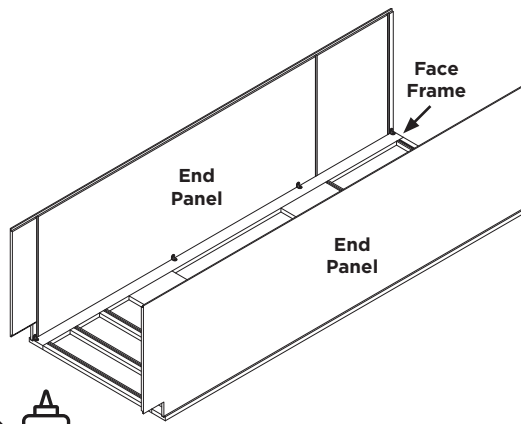

Place the face frame on covered work bench with doors facing down. Insert glue in face frame grooves and then place end panels into frame and attach with L-brackets. Ensure groove for back panel is facing up as shown.

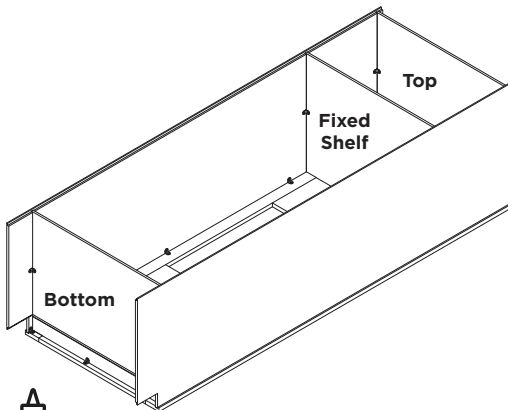

Insert glue into face frame and end panel grooves. Place the top, fixed shelf and bottom into the face frame and end panels and attach to the frame and both sides with L-brackets.

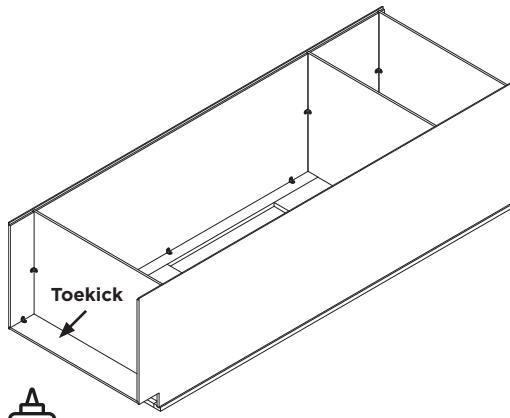

Insert glue into bottom panel and end panel grooves. Place the toekick into the end panels' bottom groove. Attach the toekick to both end panels.

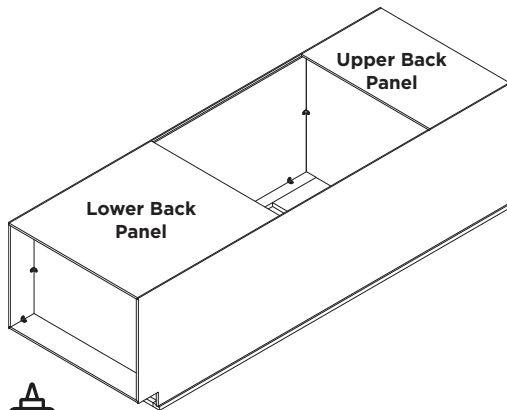

Insert glue into end panel grooves. Place the lower and upper back panels onto the end panels, top, bottom and fixed shelf.

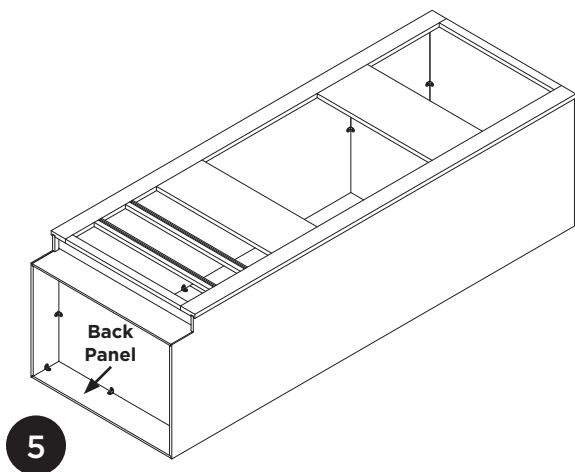

Holding the upper and lower back panels into place, flip the cabinet and attach the back panels to both end panels, top, fixed shelf and bottom with L-brackets.

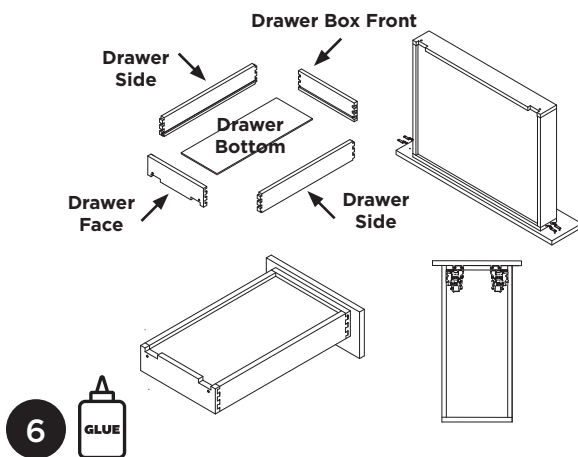

Attach drawer box front to drawer face using sturd clips. Insert glue into dovetail joints and assemble as shown. Attach the front locking clips to bottom of the drawer box.

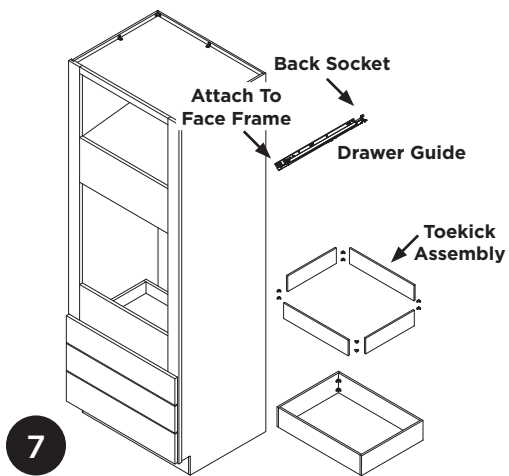

Install the drawer guides inside cabinet. Face frame holes are pre-drilled. Locate aligning holes on back panel and force fit. Place assembled drawer boxes into the cabinet.

*Note some cabinets models' holes will need to be drilled out to 5/16" for back socket.

96" Tall units: Assemble toekick pedestal by lining up corners in a rectangle and attach with L-brackets.

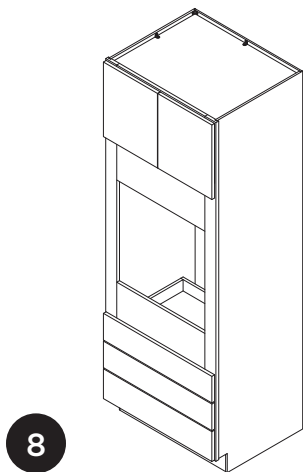

Install hinges onto doors and attach doors to face frame.

UTILITY CABINETS

General Requirements

- Prepare a protective layer prior to unboxing to prevent scratches on finished surfaces.
- All wood joints must have wood glue applied prior to assembly including drawer dovetails.
- Excess glue should be cleaned prior to drying.
- Follow specific glue recommendations for application and open times.
- Ensure panels are fully seated in grooves and top and bottom are flush with the face frame.

Supplies and Tools (not included)

- Protective covering for work table
- Drill with P2 Phillips bit (Ensure torque is set not to strip)
- Wood glue
- Wood clamp
- Rubber mallet

Tips and Tricks

- The L-bracket inside cabinet can be hidden behind the shelf.
- On larger cabinets, clamps may be used when installing the back panel to ensure it is flush with the end panels.



This icon indicates a step that requires wood glue.

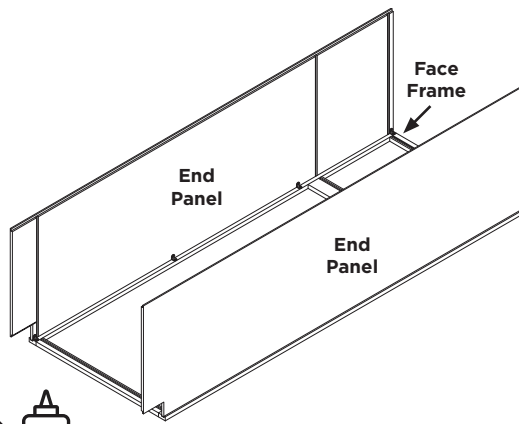

Place the face frame on covered work bench with doors facing down. Insert glue in face frame grooves and then place end panels into frame and attach with L-brackets. Ensure groove for back panel is facing up as shown.

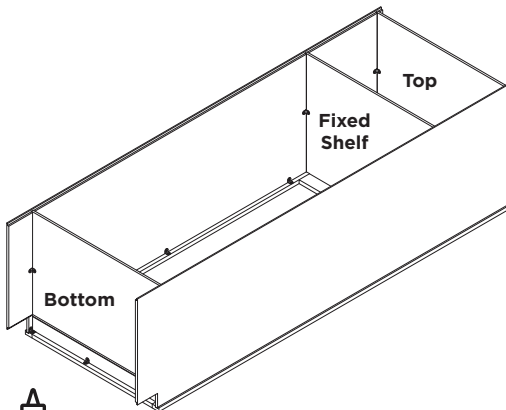

Insert glue into face frame and end panel grooves. Place the top, fixed shelf and bottom into the face frame and end panels and attach to the frame and both sides with L-brackets.

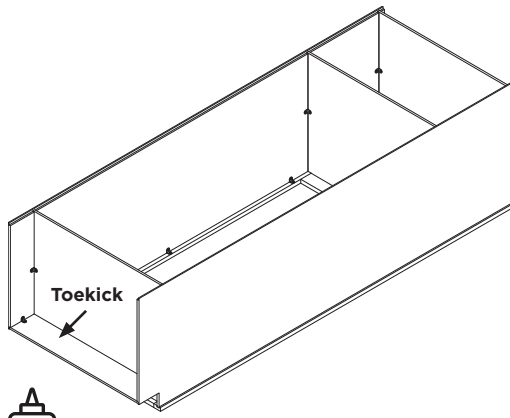

Insert glue into bottom panel and end panel grooves. Place the toe kick into end panels' bottom groove. Attach the toe kick to both end panels.

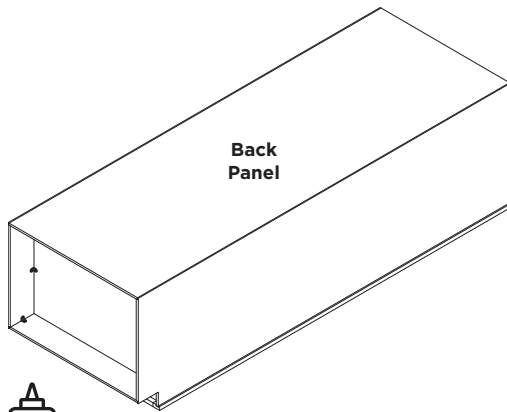

Insert glue into back panel grooves. Place the back panel onto the end panels, top, bottom and fixed shelf.

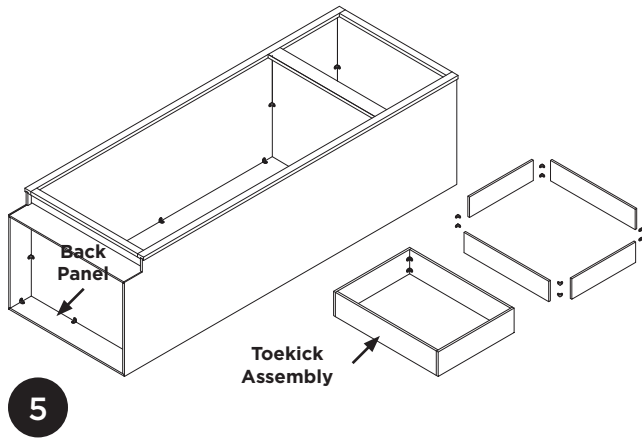

Holding the back panel in place, flip the cabinet and attach the back panel to both end panels, top, fixed shelf and bottom.

96" Tall units: Assemble toe kick pedestal by lining up corners in a rectangle and attach with L-brackets

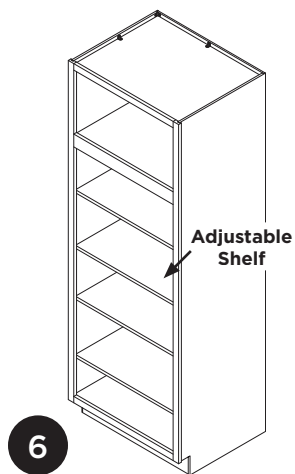

Install the adjustable shelves.

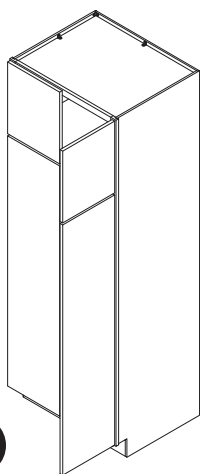

7

Attach doors to the face frame.

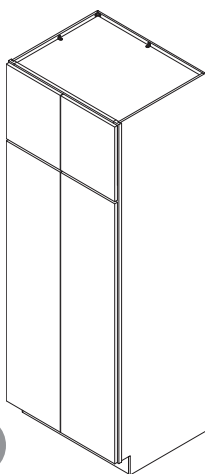

i

For more information about installation,
please visit www.mantracabinets.com

WALL CABINETS

General Requirements

- Prepare a protective layer prior to unboxing to prevent scratches on finished surfaces.
- All wood joints must have wood glue applied prior to assembly including drawer dovetails.
- Excess glue should be cleaned prior to drying.
- Follow specific glue recommendations for application and open times.
- Ensure panels are fully seated in grooves and top and bottom are flush with the face frame.

Supplies and Tools (not included)

- Protective covering for work table
- Drill with P2 Phillips bit (Ensure torque is set not to strip)
- Wood glue
- Wood clamp
- Rubber mallet

Tips and Tricks

- The L-bracket inside cabinet can be hidden behind the shelf.
- On larger cabinets, clamps may be used when installing the back panel to ensure it is flush with the end panels.



This icon indicates a step that requires wood glue.

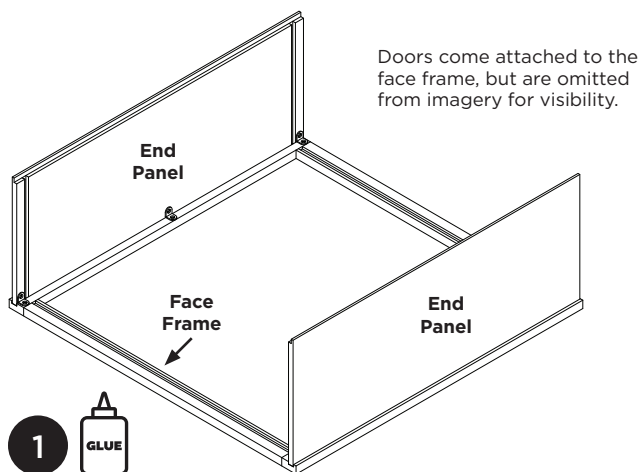

Place the face frame on covered work bench with doors facing down. Insert glue in face frame grooves and then place end panels into frame and attach with L-brackets. Ensure groove for back panel is facing up as shown.

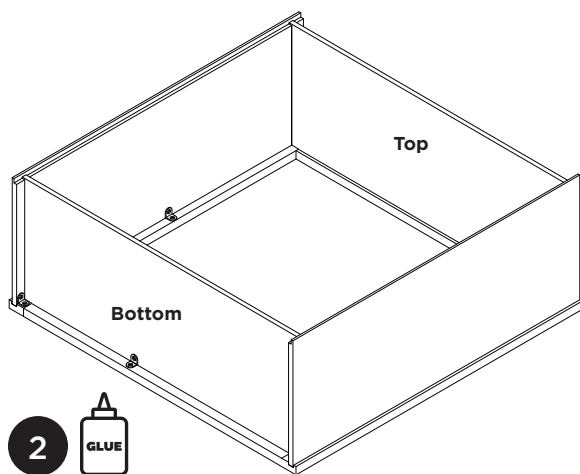

Insert glue into face frame and end panel grooves. Place top and bottom panels into grooves and attach face frame to panels with L-brackets.

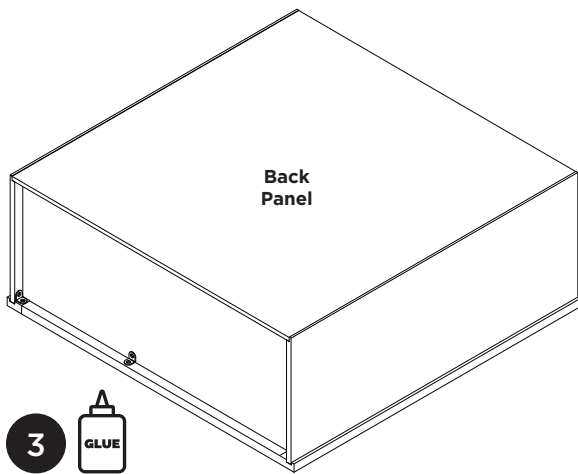

Insert glue into back panel grooves, then place back panel onto the end panels, and top and bottom panels. Ensure the ends are flush all around and attach with L-brackets.

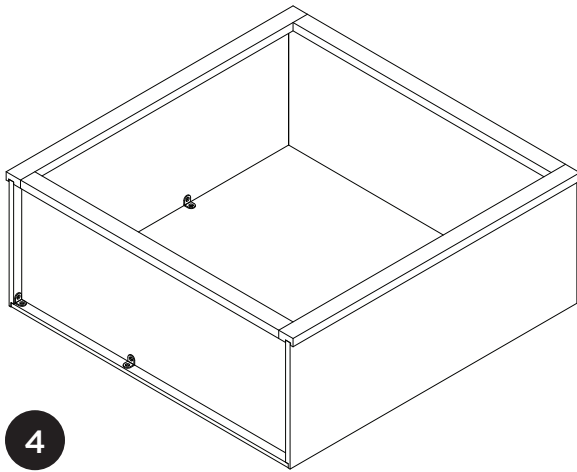

Holding the back panel into place, flip the cabinet, and attach the back panel to the sides, top and bottom with L-brackets.

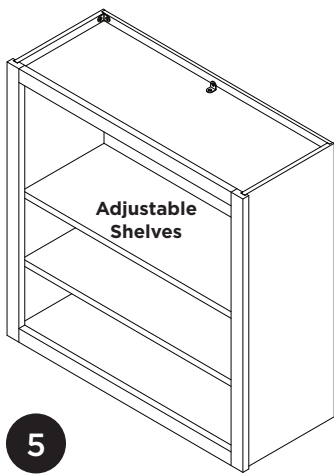

5

Install the adjustable shelves.

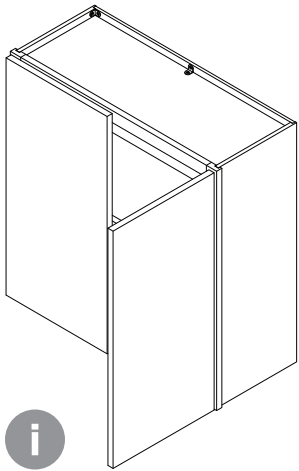

i

For more information about installation,
please visit www.mantracabinets.com

WALL CORNER CABINETS

General Requirements

- Prepare a protective layer prior to unboxing to prevent scratches on finished surfaces.
- All wood joints must have wood glue applied prior to assembly including drawer dovetails.
- Excess glue should be cleaned prior to drying.
- Follow specific glue recommendations for application and open times.
- Ensure panels are fully seated in grooves and top and bottom are flush with the face frame.

Supplies and Tools (not included)

- Protective covering for work table
- Drill with P2 Phillips bit (Ensure torque is set not to strip)
- Wood glue
- Wood clamp
- Rubber mallet

Tips and Tricks

- The L-bracket inside cabinet can be hidden behind the shelf.
- On larger cabinets, clamps may be used when installing the back panel to ensure it is flush with the end panels.



This icon indicates a step that requires wood glue.

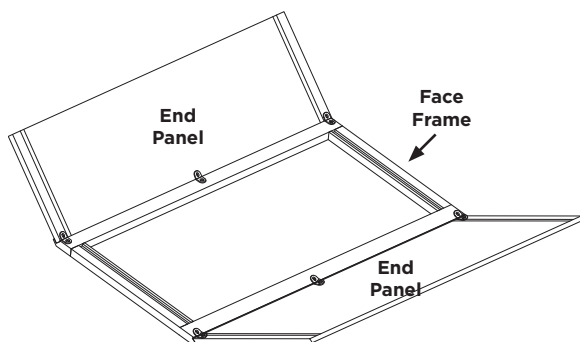

Place the face frame on covered work bench with doors facing down. Insert glue in face frame grooves and then place end panels into frame and attach with L-brackets.

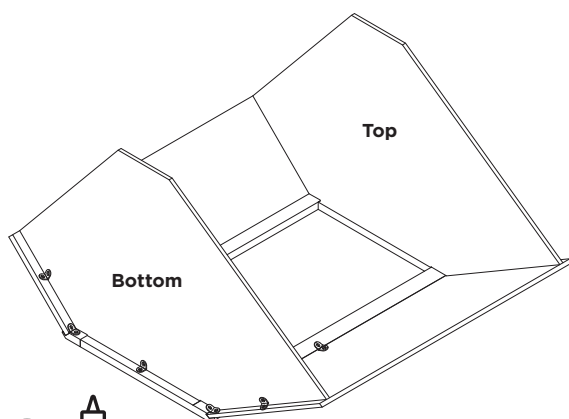

Insert glue into face frame and end panel grooves. Place the top and bottom into the face frame and end panels and attach to both the frame and end panels.

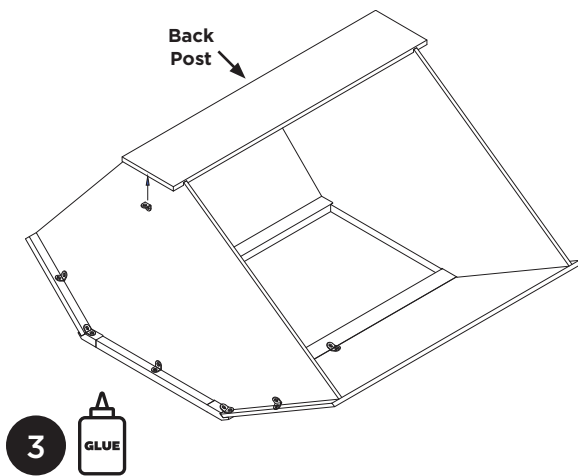

Insert glue into back post grooves. Place the back post onto the top and bottom and center the back post. Attach the back post to top and bottom.

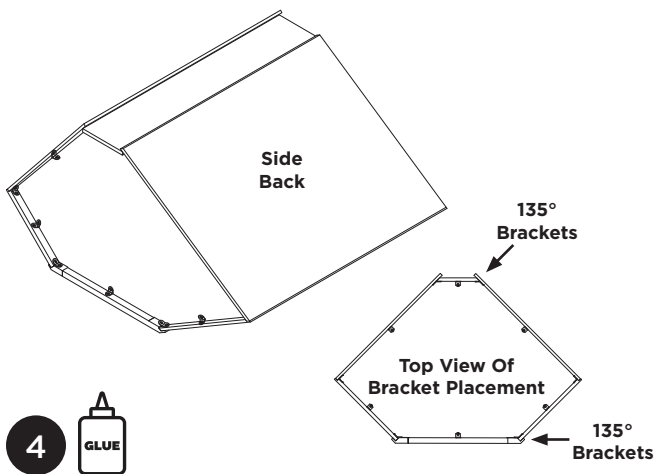

Insert glue into grooves of side panels. Place both side back panels onto the cabinet. Attach to the top and bottom end panels and back post.

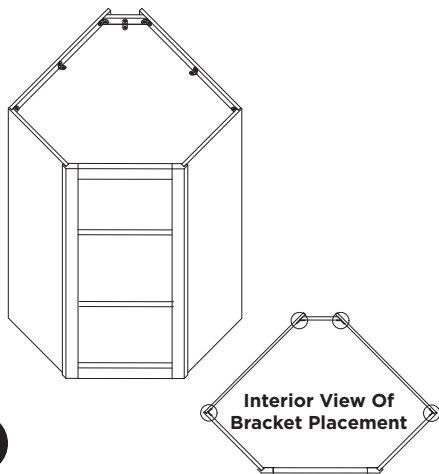

5

From inside of the cabinet, attach the side backs to the end panels and back post.

Install the adjustable shelves and attach doors to the face frame.

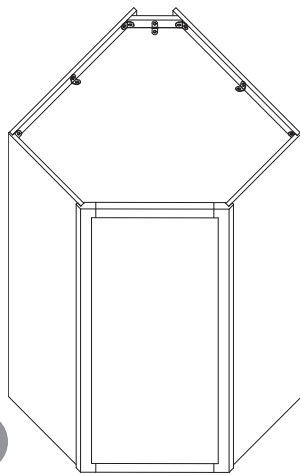

i

For more information about installation, please visit www.mantracabinets.com